

REV	DESCRIPTION	DATE
1.0	Release	20211110

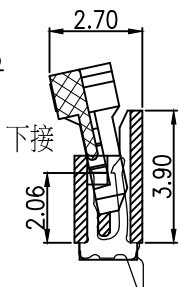

SECTION A-A

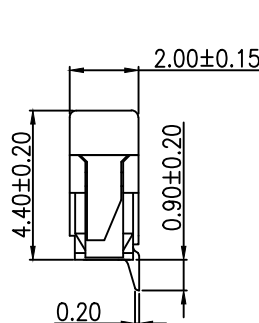
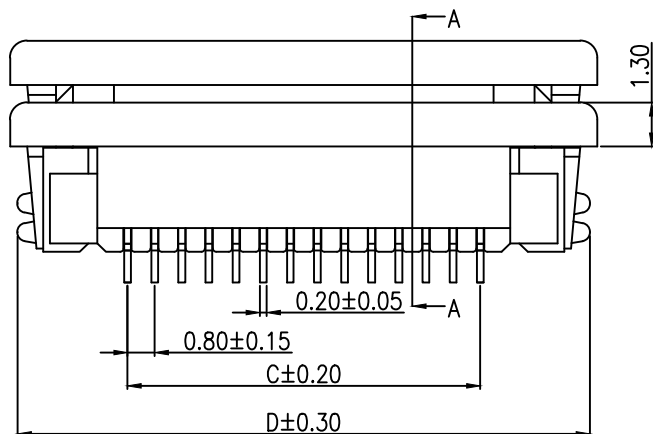
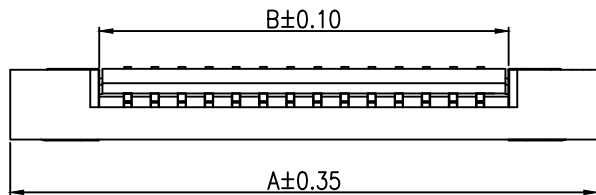
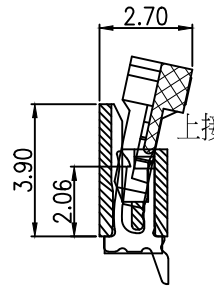

SECTION A-A

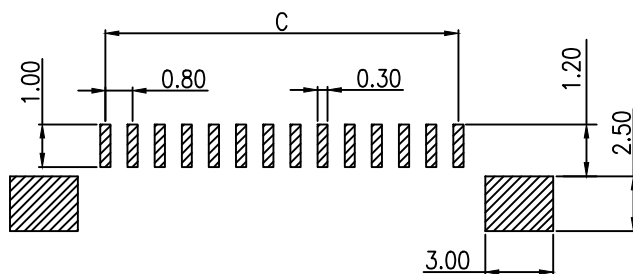

RECOMMENDED PCB LAYOUT

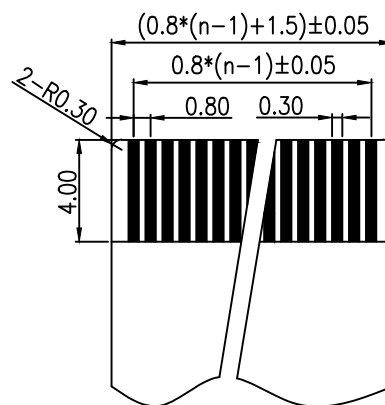
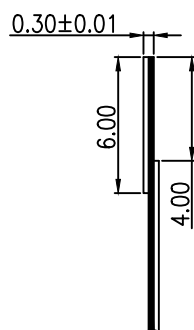

适用扁平电缆

NOTE:

■ MATERIAL AND FINISH

HOUSING:HIGH-TEMP. THERMOPLASTIC. UL 94V-0.  
 ACTUATOR:HIGH-TEMP. THERMOPLASTIC. UL 94V-0.  
 CONTACT: COPPER ALLOY.  
 PLATING: TIN OR GOLD PLATED OVER NICKEL.  
 HOLDDOWN: COPPER ALLOY. PLATING: TIN PLATED OVER NICKEL.

■ ELECTRICAL

CURRENT: 0.5A MAX.  
 DIELECTRIC WITHSTANDING VOLTAGE: 250V AC MIN.  
 CONTACT RESISTANCE: 30mΩ MAX.  
 INSULATION RESISTANCE: 100MΩ MIN.

ENVIRONMENTAL

TEMPERATURE: -25° C TO +85° C  
 WITH "A", "B", "C", "D", "O" MAJOR DIMENSION FOR QC.

■ DIMENSIONAL INFORMATION

PIN	Dimension				PIN	Dimension			
	A	B	C	D		A	B	C	D
04	10.30	4.00	2.40	9.60	23	25.50	19.20	17.60	24.80
05	11.10	4.80	3.20	10.40	24	26.30	20.00	18.40	25.60
06	11.90	5.60	4.00	11.20	25	27.10	20.80	19.20	26.40
07	12.70	6.40	4.80	12.00	26	27.90	21.60	20.00	27.20
08	13.50	7.20	5.60	12.80	27	28.70	22.40	20.80	28.00
09	14.30	8.00	6.40	13.60	28	29.50	23.20	21.60	28.80
10	15.10	8.80	7.20	14.40	29	30.30	24.00	22.40	29.60
11	15.90	9.60	8.00	15.20	30	31.10	24.80	23.20	30.40
12	16.70	10.40	8.80	16.00	31	31.90	25.60	24.00	31.20
13	17.50	11.20	9.60	16.80	32	32.70	26.40	24.80	32.00
14	18.30	12.00	10.40	17.60	33	33.50	27.20	25.60	32.80
15	19.10	12.80	11.20	18.40	34	34.30	28.00	26.40	33.60
16	19.90	13.60	12.00	19.20	35	35.10	28.80	27.20	34.40
17	20.70	14.40	12.80	20.00	36	35.90	29.60	28.00	35.20
18	21.50	15.20	13.60	20.80	37	36.70	30.40	28.80	36.00
19	22.30	16.00	14.40	21.60	38	37.50	31.20	29.60	36.80
20	23.10	16.80	15.20	22.40	39	38.30	32.00	30.40	37.60
21	23.90	17.60	16.00	23.20	40	39.10	32.80	31.20	38.40
22	24.70	18.40	16.80	24.00					

**CNT** 肯耐特电子有限公司

REV. 1.0	UNIT mm	SCALE 1:1	
-------------	------------	--------------	--

GENERAL	TOLERANCE
.X°	±5°
.X	±0.30
.XX°	±3°
.XX	±0.25
.XX°	±2°
.XX	±0.15
.XXX°	±1°
.XXX	±0.10

DRAWN	董道丽	DATE	20211110
CHECK	王芳芳	DATE	20211110
APPROVE	王元中	DATE	20211110

DWG. NO.	20211110010
PART. NO.	CNT-FPC080-XX-TDM-S21-200

TITLE  
 FPC 0.8mm PITCH 单面接  
 触 平脚位 SMT90度