

REV.	LOCALS	DESCRIPTION	DATE	DRAWN
01	NEW	BATCH PRODUCTION INITIAL RELEASE	2013.10.30	???
02	△	依業務要求增加電碼	2015.12.15	馮國東
03	△	新增SPIN:100PM 翻印車翻印器具，以舊PIN做翻印結果	2016.07.30	黃 超

Specifications

Current Rating:1.0Amp
 Insulation Resistance:1000MΩ Min.
 Dielectric Withstanding Voltage:300VAC
 Contact Resistance:20mΩ Max.
 Operating Temperature:-40°C to +105°C
 Materials
 Contact Material:Phosphor Bronze
 Insulator Material:High Temperature Thermoplastic, UL 94V-0 LCP or the equivalent material
 All materials must meet RoHS hazardous substances control standards.

PIN NO.	A	B	C	D	E	F	備註
2*05	5.08	9.50	11.30	8.30	7.30	9.08	不可量取有塑膠,無治具
2*06	6.35	10.77	12.70	9.57	8.57	10.35	具
2*10	11.43	15.85	17.65	14.65	13.65	15.43	不可量取有塑膠,無治具
2*13	15.24	19.66	21.60	18.46	17.46	19.24	具
2*25	30.48	34.90	36.80	33.70	32.70	34.48	

Recommended P.C.Board Layout (Tolerance:±0.05)

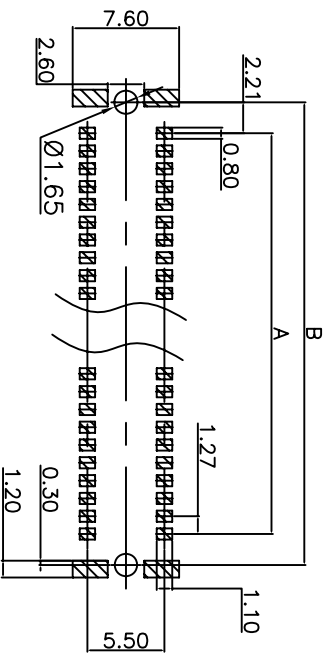

Pin NO.	Dim.H
≤25pin	0.12
>25pin	0.15

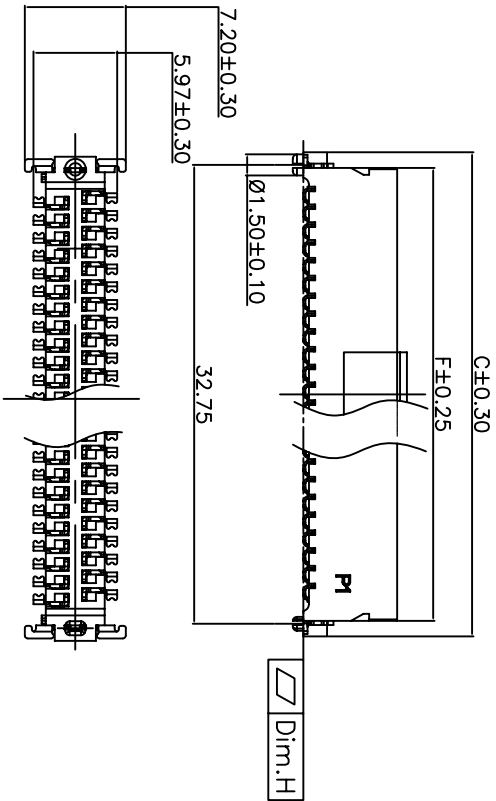
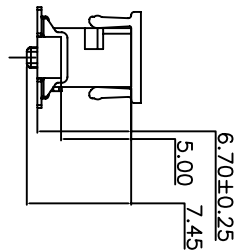
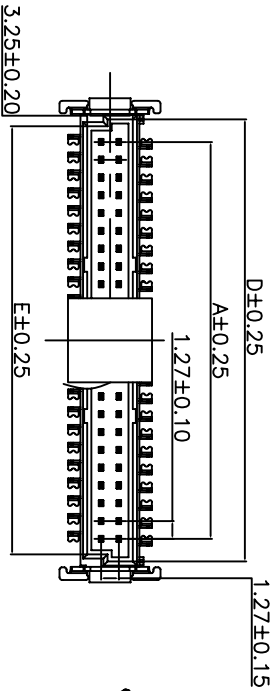
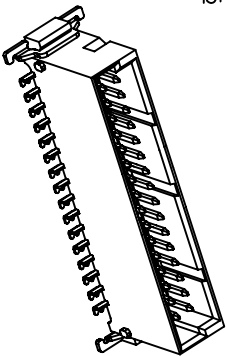

CNT 肯耐特电子有限公司

REV.	UNIT	SCALE	GENERAL TOLERANCE	DRAWN	DATE	PART. NO.	TITLE
1.0	mm	1:1	X° ±5° X ±5° XXX ±5°	Alien	20170414	CNT-B127-2*xx-QM-670/5.97-TR	PITCH 1.27 MALE CONNECTOR SMC Q TYPE SMT TYPE H6.70mm SMT
			.X° ± .X ±0.38 .XXX ±0.15	CHECK	DATE		
				APPROVE	DATE		