

P.C.B. LAYOUT

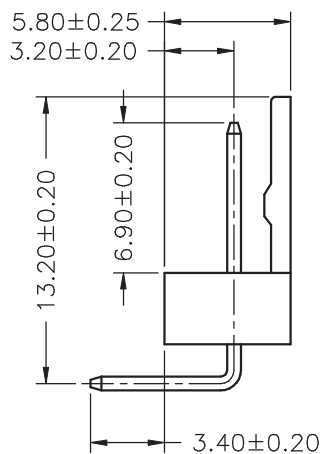
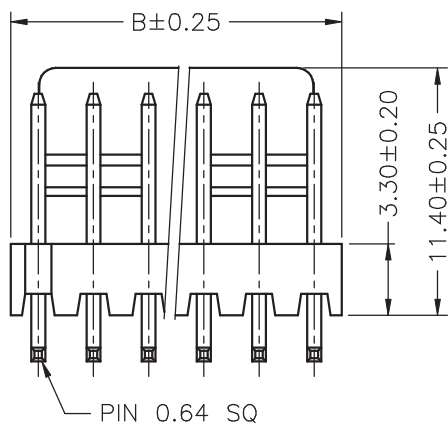
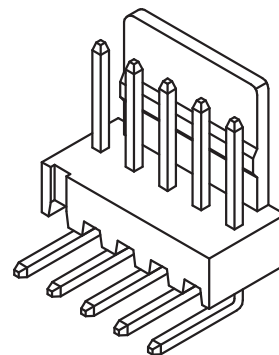

TYPE 2

SPECIFICATIONS

Current Rating: 4A AC,DC
 Voltage Rating: 250V AC,DC
 Temperature Range: $-25^{\circ}\text{C} \sim +85^{\circ}\text{C}$
 Contact Resistance: $10\text{m}\Omega$ Max
 Insulation Resistance: $1000\text{M}\Omega$ Min
 Withstanding Voltage: 1000V AC/minute
 Pin Material: Brass/Tin-plated (H65)
 Material: Nylon 66,UL94V-2 (KM-21SPC)
 Pantone Color: 7506C

Ordering Information & Dimensions

| PART NO. | Dimensions | |
|--------------|------------|-------|
| | A | B |
| A2542WR-02P2 | 2.54 | 5.08 |
| A2542WR-03P2 | 5.08 | 7.62 |
| A2542WR-04P2 | 7.62 | 10.16 |
| A2542WR-05P2 | 10.16 | 12.70 |
| A2542WR-06P2 | 12.70 | 15.24 |
| A2542WR-07P2 | 15.24 | 17.78 |
| A2542WR-08P2 | 17.78 | 20.32 |
| A2542WR-09P2 | 20.32 | 22.86 |
| A2542WR-10P2 | 22.86 | 25.40 |
| A2542WR-11P2 | 25.40 | 27.94 |
| A2542WR-12P2 | 27.94 | 30.48 |
| A2542WR-13P2 | 30.48 | 33.02 |
| A2542WR-14P2 | 33.02 | 35.56 |
| A2542WR-15P2 | 35.56 | 38.10 |
| A2542WR-16P2 | 38.10 | 40.64 |
| A2542WR-17P2 | 40.64 | 43.18 |
| A2542WR-18P2 | 43.18 | 45.72 |
| A2542WR-19P2 | 45.72 | 48.26 |
| A2542WR-20P2 | 48.26 | 50.80 |

| | | | | | |
|-------------------|-------------|----------------------|---------------------------|---------------------------|------------|
| C N T肯耐特电子有限公司 | | | | | |
| UNIT | SCALE | SHEET | TITLE: | | |
| mm | | 1 of 1 | 2.54mm PITCH 90° WAFER | | |
| DRAWN BY SUSAN | | APPROVED BY HENLY | | | |
| 2006.04.12 | | 2006.04.12 | | | |
| GENERAL TOLERANCE | | | | | |
| | X. X±0.25 | ANGLE± | | | |
| A0 | NEW RELEASE | 2006.04.12 | X. XX±0.15 | DRAW NO. : A2542WR-XP2 | |
| REV. | DESCRIPTION | DATE | X. XXX±0.05 | | REV. A0 |